

自动扶梯驱动主机

Escalator driving machine

ET160-II

产品特点 Product Characteristics

产品自重: 355kg

噪音级别: <58dB(A)

扭转振动: <2.0mm/s

水平和垂直振动: <0.8~1.2mm/s

额定输出扭矩: 1072N·m~2925N·m

置式: 左置或右置 (此图为右置)

Deadweight: 355kg

Noise level: <58dB(A)

Torsional vibration: <2.0mm/s

Horizontal and vertical vibrations: <0.8~1.2mm/s

Rated output torque: 1072N·m~2925N·m

Arrangement: left side or right side (The picture is for right side)



外形和安装尺寸 Overall dimensions and mounting dimensions

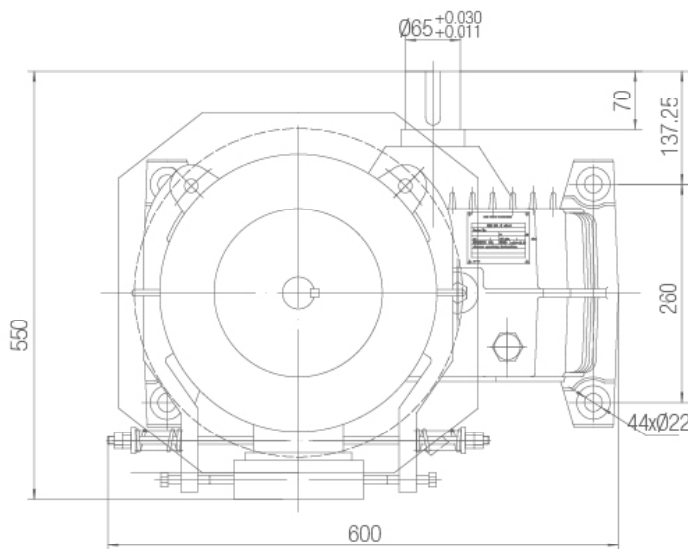
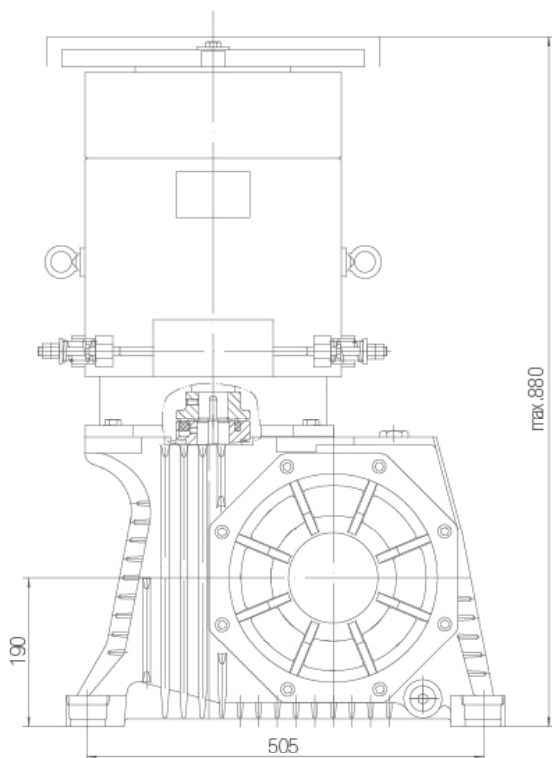

型号 Type	规格 Specification	输出扭矩 Output Torque (N·m)	速比 Reduction Ratio	电机型号 Type of Motor	功率 Power (kw)	电机转速 Motor Speed (r/min)	电源 Power Source (V/Hz)	电流 Current (A)	制动电压 Brake Voltage (V)
ET160-II	X	1072	2:49	YFTII160S-6	5.50	960	380/50	13.8	AC220
	XI	1560		YFTII160S1-6	8.00			18.5	
	XII	2145		YFTII160L1-6	11.0			24.5	
	XIV	2925		YFTII160L2-6	15.0			32.5	